

MBRC



MEDIUM PRESSURE FAN WITH BACKWARD IMPELLER

MANUFACTURING FEATURES:

- Reinforced rolling steel sheet housings completely welded (internally and externally) with epoxy powder finishing coat.
- Reinforced high efficiency backward curved impeller.
- Standard asynchronous squirrel-cage motor with IP-55 protection and rated class F insulation. Standard voltages 230V 50Hz for single phase motors, 230/400V 50Hz for three phase motors up to 4kW and 400/690V 50Hz for higher powers.
- Standard orientation: LG270.

APPLICATIONS:

Designed for inline installation, they are suitable for:

- Industrial applications, extraction or injection of air.
- Hot air exhaust in ovens or facilities with high temperatures.
- Clean and slightly dusty air transport.
- Maximum working temperature: carried air: 250°C, ambient: 1ph 50°C, 3ph 60°C.

Accessories



AC



BAD



EI



**FILTRO
EMC**



INT



JE-45



RA



RBS



SFC

UNDER REQUEST:

- 2 speed motors.
- Orientation: LG0, LG90, LG180.

Technical data

Single-phase motor / 4 poles

Code	Model	R.P.M.	Rated I. (A) 230V	Rated power kW	Max. Airflow m3/h	Sound db (A)*	Weight	Connect. diagram
243400143	MBRC 40/12 M4 0,75kW	1400	5,21	0,75	5.640	59	71	1
243450143	MBRC 45/14 M4 1,1kW	1400	7,45	1,10	7.000	62	90	1
243510143	MBRC 50/16 M4 1,5kW	1400	9,83	1,50	9.500	64	116	1

Single-phase motor / 6 poles

Code	Model	R.P.M.	Rated I. (A) 230V	Rated power kW	Max. Airflow m3/h	Sound db (A)*	Weight	Connect. diagram
243500143	MBRC 50/16 M6 0,75kW	900	4,9	0,75	7.100	54	116	1

Three-phase motor / 2 poles

Code	Model	R.P.M.	Rated I. (A) 400V	Rated power kW	Max. Airflow m3/h	Sound db (A)*	Weight	Connect. diagram
243310146	MBRC 31/10 T2 1,1kW	2800	2,33	1,10	4.800	68	42	2
243350146	MBRC 35/11 T2 2,2kW	2800	4,58	2,20	6.660	71	55	2
243410146	MBRC 40/12 T2 3kW	2870	5,92	3	8.500	74	98	2

Three-phase motor / 4 poles

Code	Model	R.P.M.	Rated I. (A) 400V	Rated power kW	Max. Airflow m3/h	Sound db (A)*	Weight	Connect. diagram
243400146	MBRC 40/12 T4 0,75kW	1390	1,63	0,75	5.640	59	71	2
243450146	MBRC 45/14 T4 1,1kW	1400	2,49	1,10	7.000	62	90	2
243510146	MBRC 50/16 T4 1,5kW	1400	3,26	1,50	9.500	64	116	2
243570146	MBRC 56/18 T4 3kW	1430	6,17	3	13.500	70	150	2
243650146	MBRC 63/20 T4 5,5kW	1440	10,5	5,50	19.000	71	220	2
243730146	MBRC 71/22 T4 7,5kW	1440	14,1	7,50	25.500	77	316	2

Three-phase motor / 6 poles

Code	Model	R.P.M.	Rated I. (A) 400V	Rated power kW	Max. Airflow m3/h	Sound db (A)*	Weight	Connect. diagram
243500146	MBRC 50/16 T6 0,75kW	910	1,95	0,75	7.100	54	116	2

Code	Model	R.P.M.	Rated I. (A) 400V	Rated power kW	Max. Airflow m3/h	Sound db (A)*	Weight	Connect. diagram
243560146	MBRC 56/18 T6 1,5kW	940	3,71	1,50	9.500	61	142	2
243640146	MBRC 63/20 T6 1,5kW	940	3,71	1,50	12.000	62	208	2
243720146	MBRC 71/22 T6 3kW	960	7,3	3	17.000	68	294	2

Notes:
 * Total sound pressure level at the point of maximum flow measured in dB(A) in the suction measured in free field at a distance of 6m from the source

Dimensions

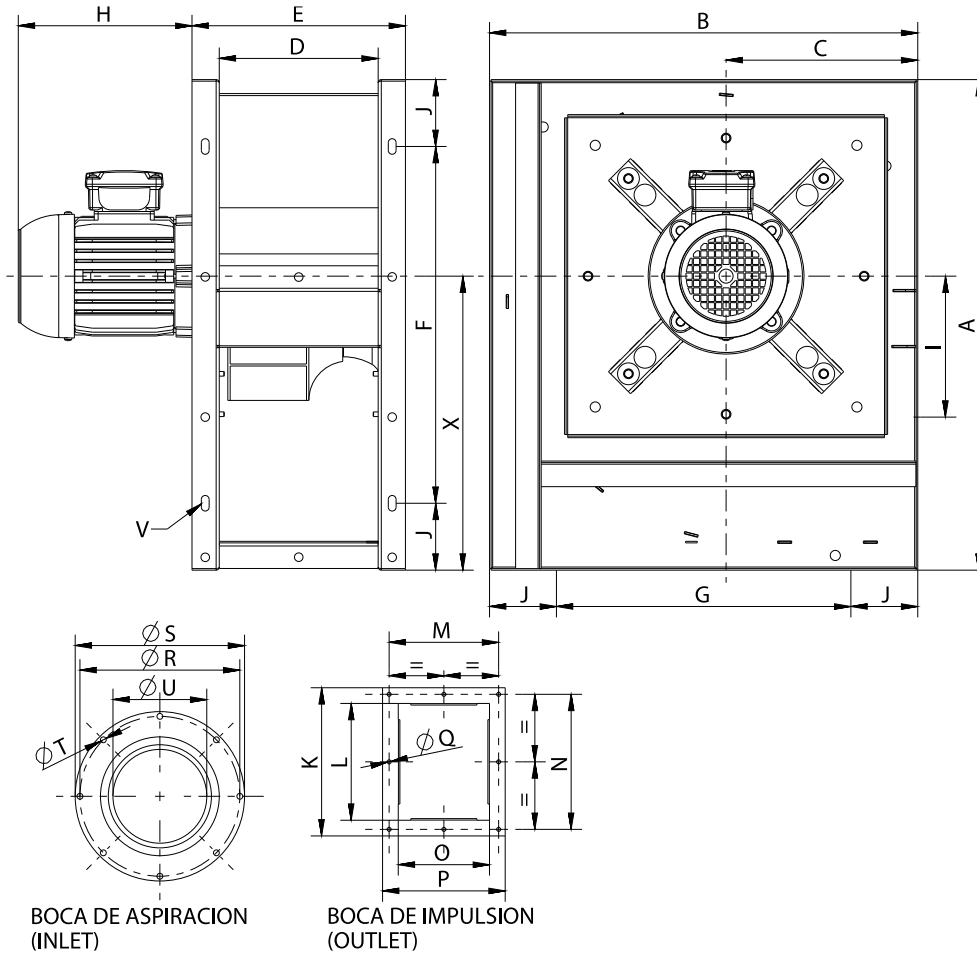

Model	A	B	C	D	E	F	G	H	I
MBRC 31/10 T2 1,1kW	630	550	246	204	274	458	378	300	181
MBRC 35/11 T2 2,2kW	700	602	267	230	300	528	430	300	243
MBRC 40/12 M4 0,75kW	790	670	292	254	334	618	498	225	270
MBRC 40/12 T2 3kW	790	670	292	254	334	618	498	320	270
MBRC 40/12 T4 0,75kW	790	670	292	254	334	618	498	225	270
MBRC 45/14 M4 1,1kW	880	760	326	280	360	708	588	240	305
MBRC 45/14 T4 1,1kW	880	760	326	280	360	708	588	240	305
MBRC 50/16 M4 1,5kW	972	830	351	322	402	800	658	265	311
MBRC 50/16 M6 0,75kW	972	830	351	322	402	800	658	240	311
MBRC 50/16 T4 1,5kW	972	830	351	322	402	800	658	265	311
MBRC 50/16 T6 0,75kW	972	830	351	322	402	800	658	240	311
MBRC 56/18 T4 3kW	1080	920	400	361	441	908	748	300	378
MBRC 56/18 T6 1,5kW	1080	920	400	361	441	908	748	300	378
MBRC 63/20 T4 5,5kW	1220	1035	439	406	506	1048	863	365	439

Model	A	B	C	D	E	F	G	H	I
MBRC 63/20 T6 1,5kW	1220	1035	439	406	506	1048	863	365	439
MBRC 71/22 T4 7,5kW	1380	1178	497	453	553	1208	1006	380	475
MBRC 71/22 T6 3kW	1380	1178	497	453	553	1208	1006	365	475

Model	J	K	L	M	N	O	P	Q	R
MBRC 31/10 T2 1,1kW	86	393	321	240	360	204	274	11	355
MBRC 35/11 T2 2,2kW	86	356	282	266	318	230	300	11	395
MBRC 40/12 M4 0,75kW	86	406	322	300	370	254	334	11	438
MBRC 40/12 T2 3kW	86	406	322	300	370	254	334	11	438
MBRC 40/12 T4 0,75kW	86	406	322	300	370	254	334	11	438
MBRC 45/14 M4 1,1kW	86	444	360	328	404	280	360	11	485
MBRC 45/14 T4 1,1kW	86	444	360	328	404	280	360	11	485
MBRC 50/16 M4 1,5kW	86	540	458	365	500	322	402	11	485
MBRC 50/16 M6 0,75kW	86	540	458	365	500	322	402	11	485
MBRC 50/16 T4 1,5kW	86	540	458	365	500	322	402	11	485
MBRC 50/16 T6 0,75kW	86	540	458	365	500	322	402	11	485
MBRC 56/18 T4 3kW	86	534	450	390	491	361	441	11	608
MBRC 56/18 T6 1,5kW	86	534	450	390	491	361	441	11	608
MBRC 63/20 T4 5,5kW	86	608	504	441	546	406	506	17	675
MBRC 63/20 T6 1,5kW	86	608	504	441	546	406	506	17	675
MBRC 71/22 T4 7,5kW	86	677	573	500	620	453	553	17	755
MBRC 71/22 T6 3kW	86	677	573	500	620	453	553	17	755

Model	S	T	U	V	X
MBRC 31/10 T2 1,1kW	11	-	257	10x20	377
MBRC 35/11 T2 2,2kW	422	11	289	10X20	420
MBRC 40/12 M4 0,75kW	464	11	257	10x20	473
MBRC 40/12 T2 3kW	464	11	257	10x20	473
MBRC 40/12 T4 0,75kW	464	11	257	10x20	473
MBRC 45/14 M4 1,1kW	515	11	289	10x20	527
MBRC 45/14 T4 1,1kW	515	11	289	10x20	527
MBRC 50/16 M4 1,5kW	565	11	325	10x20	582
MBRC 50/16 M6 0,75kW	565	11	325	10x20	582
MBRC 50/16 T4 1,5kW	565	11	325	10x20	582
MBRC 50/16 T6 0,75kW	565	11	325	10x20	582
MBRC 56/18 T4 3kW	640	11	365	10x20	645
MBRC 56/18 T6 1,5kW	640	11	365	10x20	645
MBRC 63/20 T4 5,5kW	710	11	410	10X20	731
MBRC 63/20 T6 1,5kW	710	11	410	10x20	731
MBRC 71/22 T4 7,5kW	785	11	460	10X20	814

Model	S	T	U	V	X
MBRC 71/22 T6 3kW	785	11	460	10x20	814

Wiring diagram

DIAGRAM Nº 1

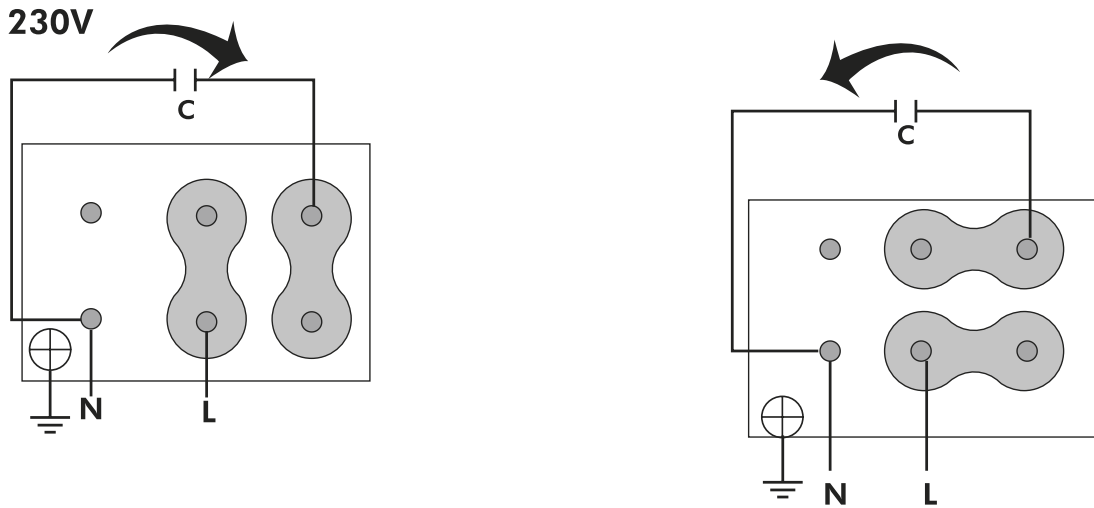
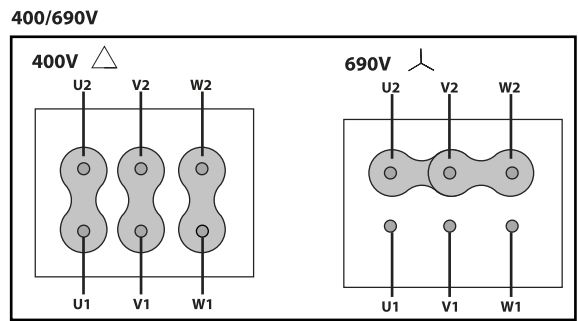
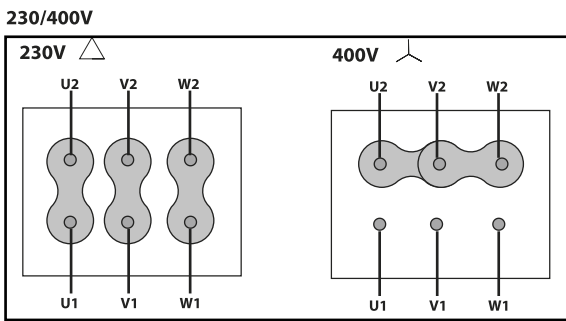

DIAGRAM Nº 2



CHARACTERISCTIC CURVE

- 1 MBRC 40/12 M4 0,75kW
- 2 MBRC 45/14 M4 1,1kW
- 3 MBRC 50/16 M4 1,5kW

AIR FLOW - PRESSURE

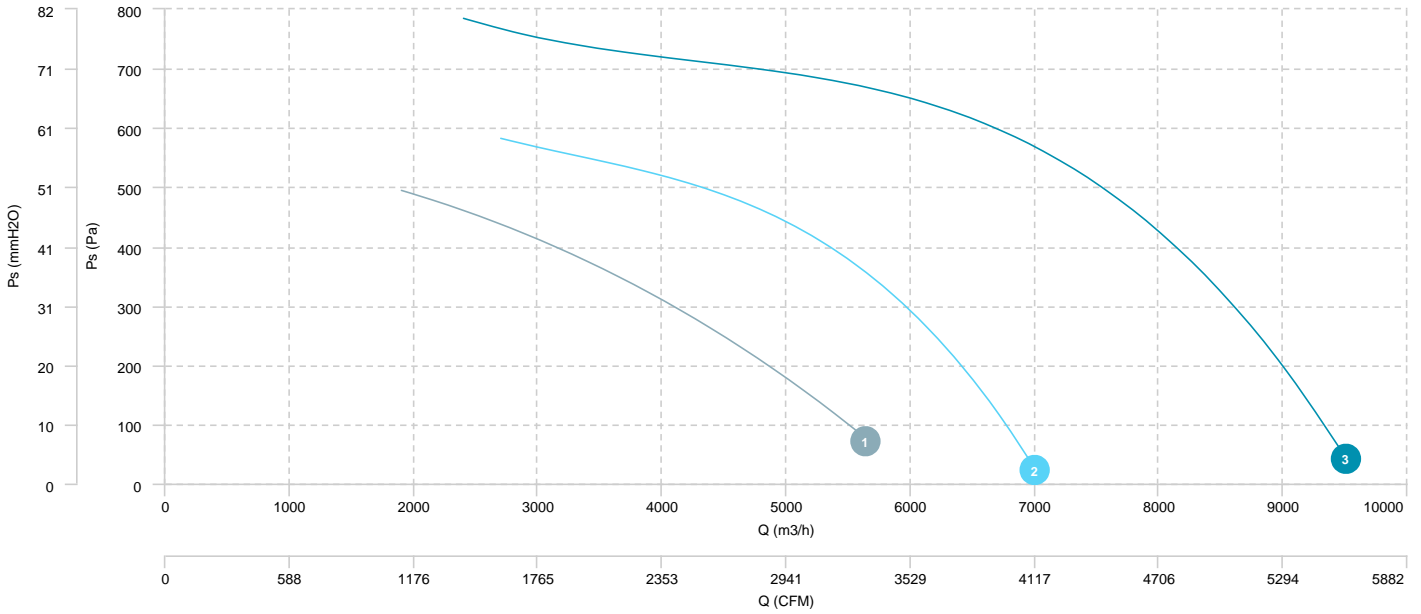

1 MBRC 50/16 M6 0,75kW

AIR FLOW - PRESSURE

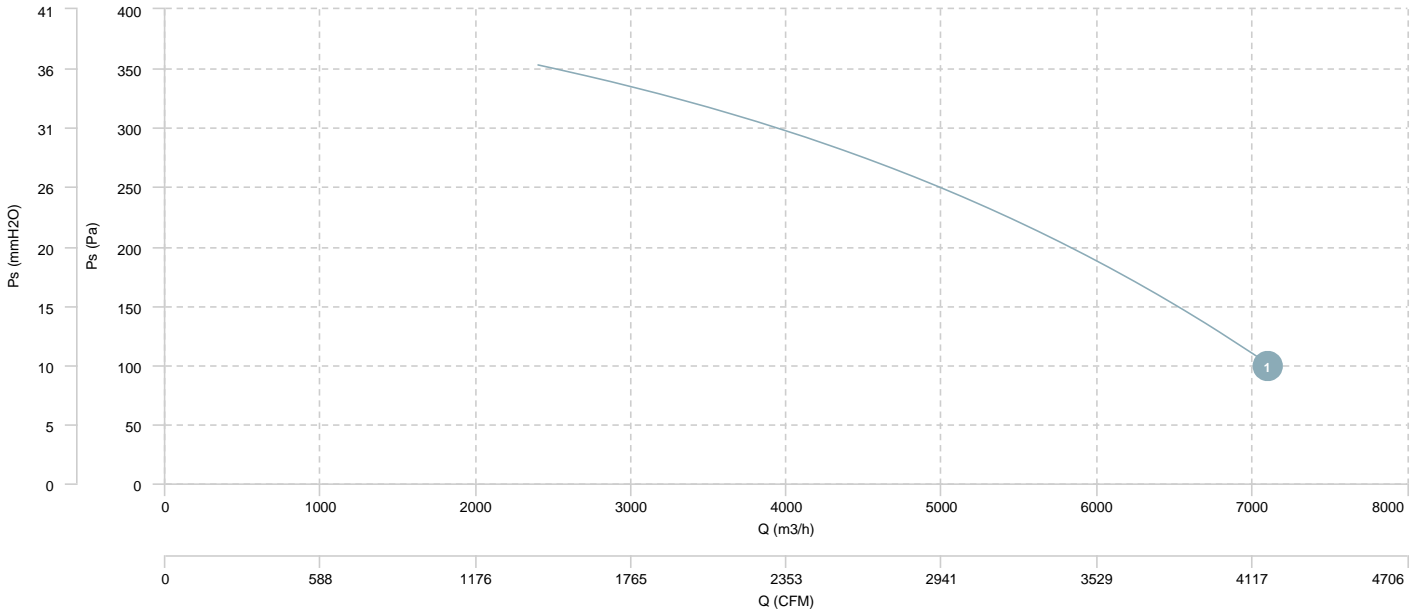

1 MBRC 31/10 T2 1,1kW

2 MBRC 35/11 T2 2,2kW

3 MBRC 40/12 T2 3kW

AIR FLOW - PRESSURE

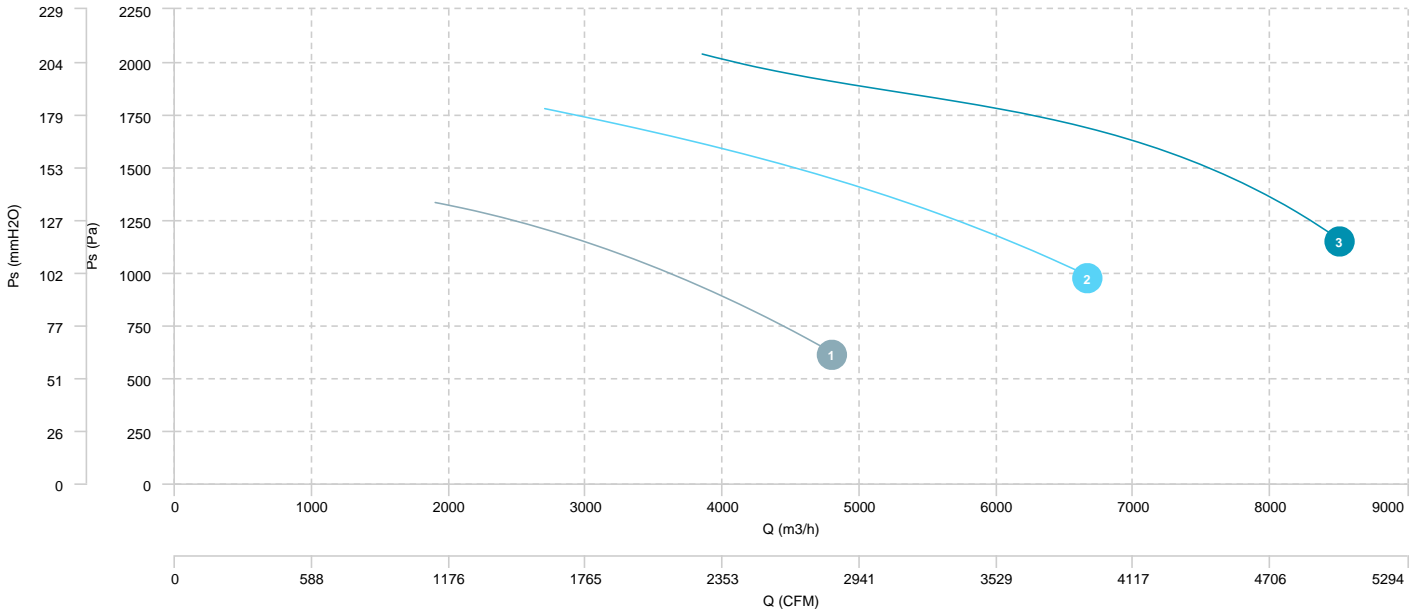

1	MBRC 40/12 T4 0,75kW	2	MBRC 45/14 T4 1,1kW	3	MBRC 50/16 T4 1,5kW	4	MBRC 56/18 T4 3kW
5	MBRC 63/20 T4 5,5kW	6	MBRC 71/22 T4 7,5kW				

AIR FLOW - PRESSURE

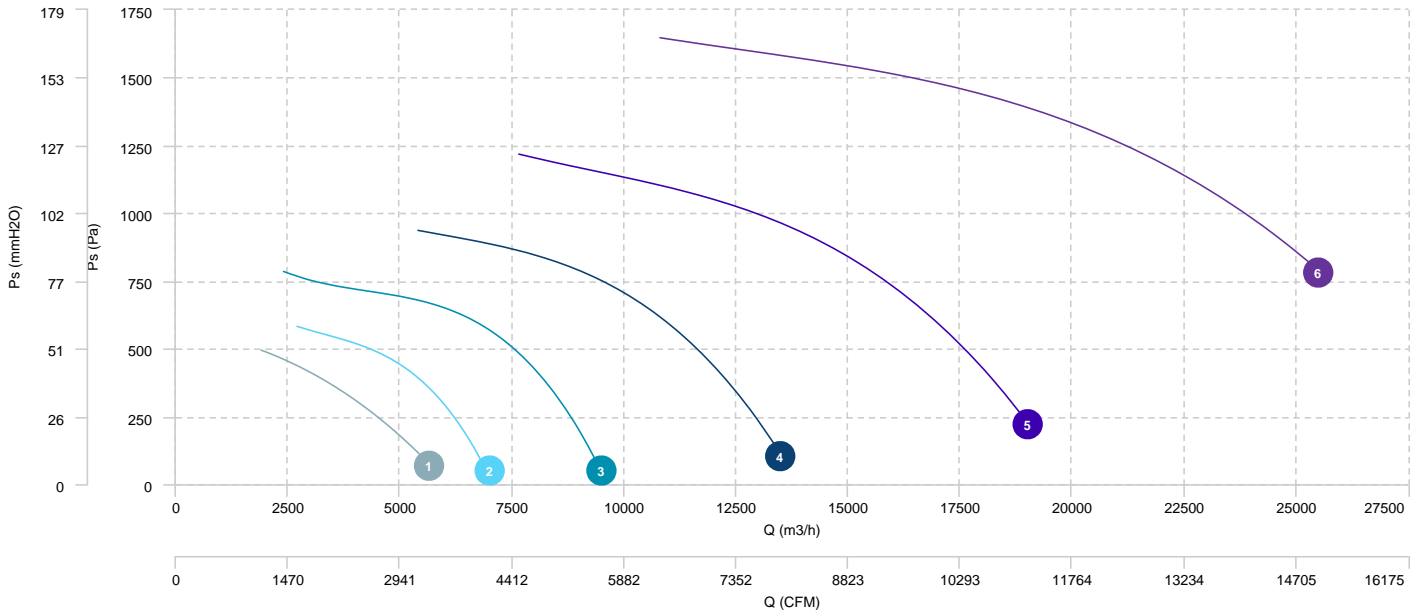

1 MBRC 50/16 T6 0,75kW

2 MBRC 56/18 T6 1,5kW

3 MBRC 63/20 T6 1,5kW

4 MBRC 71/22 T6 3kW

AIR FLOW - PRESSURE

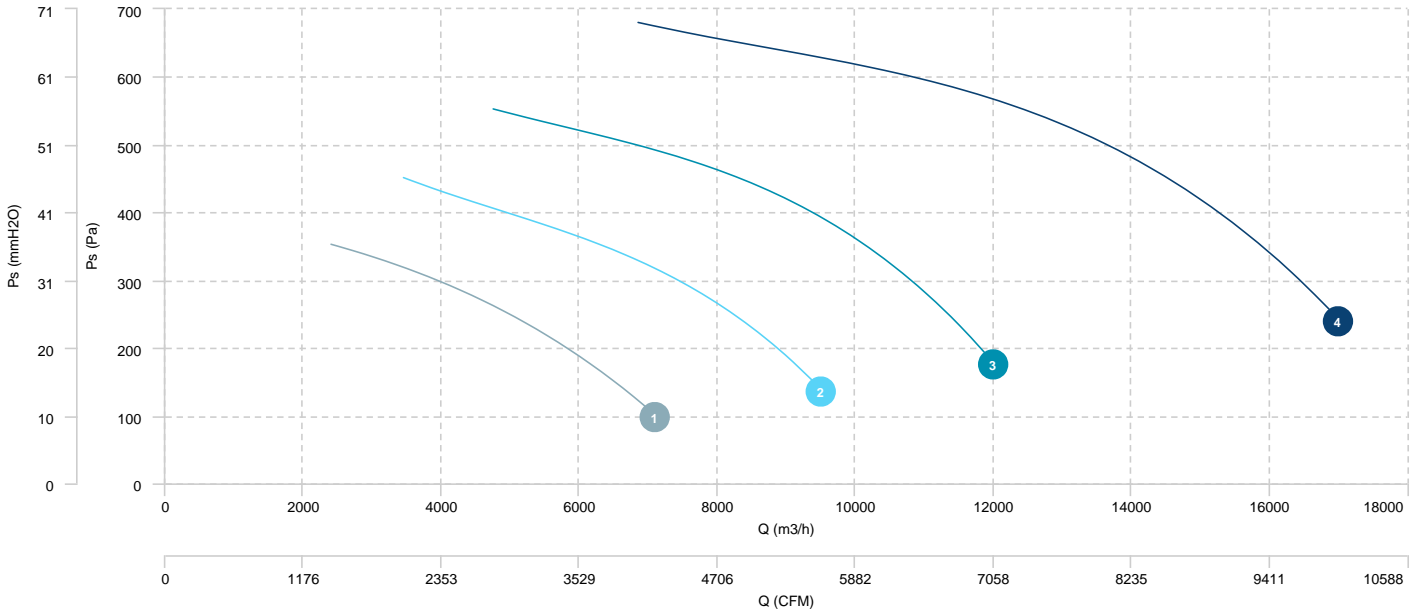

Sound data

Sound / 2 poles

Sound power Lw dB (A)										
Model		63 Hz	125 Hz	250 Hz	500 Hz	1000 Hz	2000 Hz	4000 Hz	8000 Hz	Total
MBRC 31/10 T2 1,1kW	Inlet	65	78	78	91	86	86	86	79	94
MBRC 35/11 T2 2,2kW	Inlet	72	79	77	89	87	93	92	79	97
MBRC 40/12 T2 3kW	Inlet	68	83	81	93	90	94	96	83	100

Sound / 4 poles

Sound power Lw dB (A)										
Model		63 Hz	125 Hz	250 Hz	500 Hz	1000 Hz	2000 Hz	4000 Hz	8000 Hz	Total
MBRC 40/12 M4 0,75kW	Inlet	56	70	76	79	79	80	70	59	85
MBRC 40/12 T4 0,75kW	Inlet	56	70	76	79	79	80	70	59	85
MBRC 45/14 M4 1,1kW	Inlet	59	72	78	83	80	83	78	64	88
MBRC 45/14 T4 1,1kW	Inlet	59	72	78	83	80	83	78	64	88
MBRC 50/16 M4 1,5kW	Inlet	64	74	82	84	83	85	76	66	90
MBRC 50/16 T4 1,5kW	Inlet	64	74	82	84	83	85	76	66	90
MBRC 56/18 T4 3kW	Inlet	69	78	91	87	90	91	85	71	96
MBRC 63/20 T4 5,5kW	Inlet	80	85	91	93	91	88	81	73	97
MBRC 71/22 T4 7,5kW	Inlet	83	84	93	96	98	99	95	82	103

Sound / 6 poles

Sound power Lw dB (A)										
Model		63 Hz	125 Hz	250 Hz	500 Hz	1000 Hz	2000 Hz	4000 Hz	8000 Hz	Total
MBRC 50/16 M6 0,75kW	Inlet	53	65	72	77	73	69	62	54	80
MBRC 50/16 T6 0,75kW	Inlet	53	65	72	77	73	69	62	54	80
MBRC 56/18 T6 1,5kW	Inlet	61	69	81	83	80	81	71	60	87
MBRC 63/20 T6 1,5kW	Inlet	69	70	82	82	81	83	73	63	88
MBRC 71/22 T6 3kW	Inlet	73	73	87	86	90	90	79	68	94