

RP



INLET-OUTLET PROTECTION GUARD

Protection guard at the side of impeller and motor in long casing models.
 Protection guard only in impeller side in short casing models.
 Specially designed to avoid entrance of objects and in contact with impeller.
 Manufactured of welded metal wire.
 According to ROHS 2002/95/EC (restriction of use in certain hazardous substances on electrical and electronic equipments)

Fans



Technical data

| Code | Model | Weight |
|-----------|--------|--------|
| 960300100 | RP 35 | 1,50 |
| 960300101 | RP 40 | 1,70 |
| 960310100 | RP 45 | 1,90 |
| 960320100 | RP 50 | 2,20 |
| 960330100 | RP 56 | 3,50 |
| 960330101 | RP 63 | 3,70 |
| 960340100 | RP 71 | 4,10 |
| 960340101 | RP 80 | 4,70 |
| 960340102 | RP 90 | 7,30 |
| 960340103 | RP 100 | 8,20 |
| 960340105 | RP 112 | 9,40 |
| 960340104 | RP 125 | 10,10 |

Dimensions

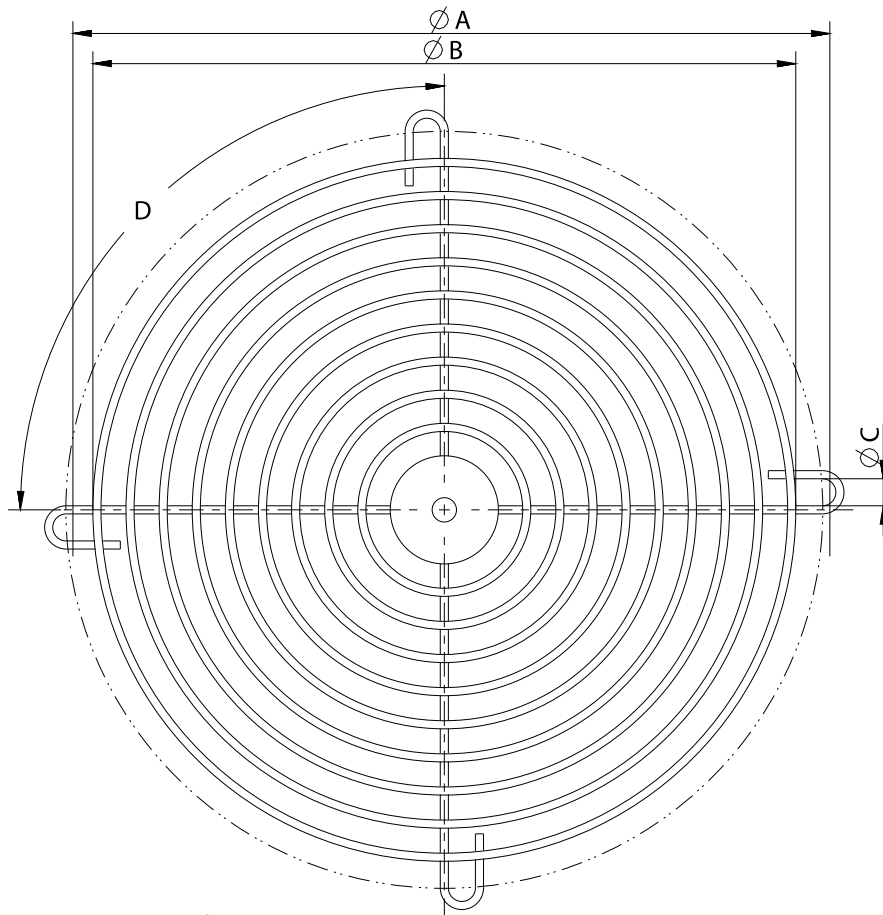

NOTA: Cota maxima entre barillas 10mm.

| Model | D | Ø A | Ø B | Ø C |
|--------|-------|------|------|-----|
| RP 35 | 4x90° | 395 | 348 | 10 |
| RP 40 | 4x90° | 450 | 414 | 10 |
| RP 45 | 4x90° | 500 | 458 | 10 |
| RP 50 | 4x90° | 560 | 531 | 10 |
| RP 56 | 4x90° | 620 | 590 | 10 |
| RP 63 | 4x90° | 690 | 650 | 10 |
| RP 71 | 4x90° | 770 | 720 | 10 |
| RP 80 | 8x45° | 860 | 820 | 10 |
| RP 90 | 8x45° | 970 | 935 | 10 |
| RP 100 | 8x45° | 1070 | 1028 | 10 |
| RP 112 | 8x45° | 1190 | 1152 | 18 |
| RP 125 | 8x45° | 1320 | 1280 | 18 |